

NOTE:

1. REMEMBER TO INSTALL INTERNATIONAL TPO UNREINFORCED OR PREMANUFACTURED OUTSIDE CORNERS TO THE SCUPPERS' FOUR ROOF SIDE CORNERS.
2. OPTIONS 1 & 2 EITHER PRE-FAB OR FIELD FAB.
3. PLATES & SCREWS 6" O.C. REQ'D FOR BALLAST SYSTEMS.
4. APPLY INTERNATIONAL TPO CUT EDGE SEALANT TO ALL CUT REINFORCED TPO EDGES.

INTERNATIONAL TPO

COATED METAL WALL SCUPPER

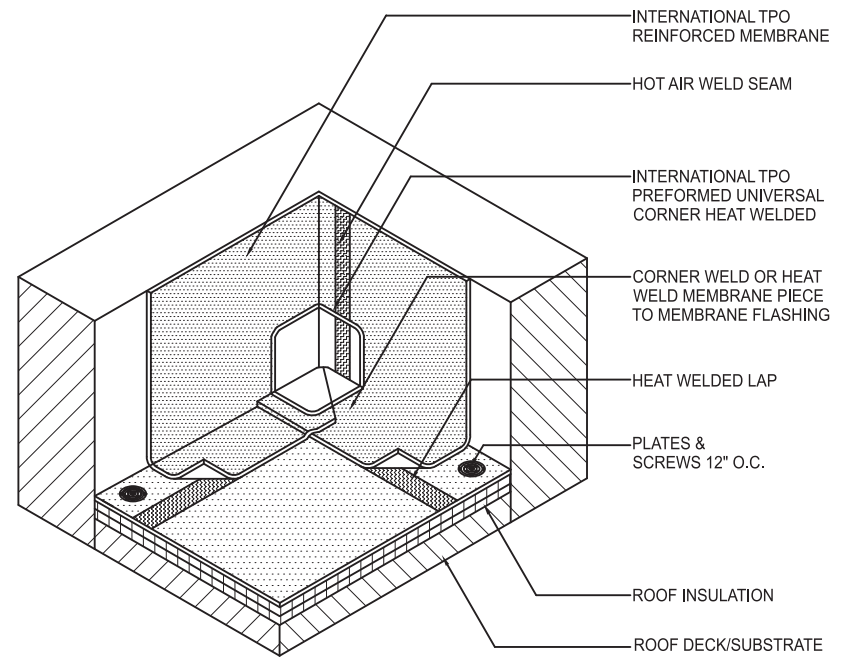

NOTE:

1. INSIDE CORNERS MAY ALSO BE FIELD FABRICATED USING UNREINFORCED MEMBRANE.
2. APPLY INTERNATIONAL TPO CUT EDGE SEALANT TO ALL CUT REINFORCED TPO EDGES.

INTERNATIONAL TPO

PRE-FORMED INSIDE CORNER

